



*"Experts in Specialist
Wheels & Tyres"*

PRODUCT INFORMATION

300 Series Bolt Hole Castor

Material: Zinc plated swivel bracket with bolt hole fitting. Wheel with black solid standard rubber tyre on zinc plated pressed steel centre.

Part number:	299778
Wheel diameter (D):	100mm
Tread width (T2):	30mm
Tread hardness:	85° Shore A
Wheel bearing:	Roller bearing
Top plate diameter (C):	71mm
Bolt hole (d):	10,5mm
Offset (F):	38mm
Overall height (H):	127mm
Load capacity 3km/h:	90kg
Rolling resistance:	Reasonable
Operating noise:	Very good
Floor preservation:	Very good

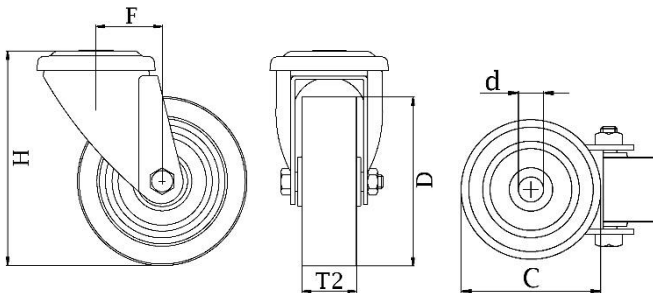

Telephone: (353) 1 452 0482
Email: info@parnells.eu

www.parnells.eu

Unit A1 - A2
Southcity Business Centre
Whitestown Way
Tallaght
Dublin D24 HT95
Ireland