



*"Experts in Specialist
Wheels & Tyres"*

PRODUCT INFORMATION

300 Series Bolt Hole Castor

Material: Zinc plated swivel bracket with bolt hole fitting. White polypropylene wheel.

Part number:	352534
Wheel diameter (D):	80mm
Tread width (T2):	30mm
Tread hardness:	70° shore D
Wheel bearing:	Roller bearing
Top plate diameter (C):	71mm
Bolt hole (d):	10.5mm
Offset (F):	35mm
Overall height (H):	108mm
Load capacity 3km/h:	120kg
Rolling resistance:	Excellent
Operating noise:	Reasonable
Floor preservation:	Reasonable

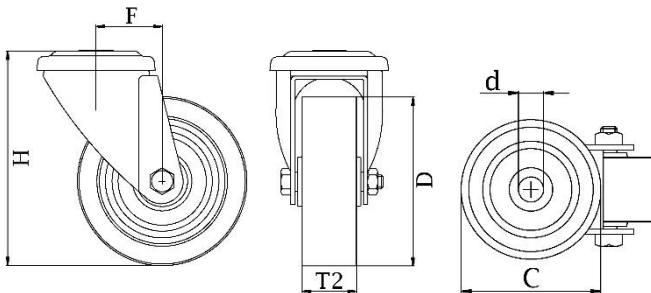

Telephone: (353) 1 452 0482
Email: info@parnell.eu

www.parnells.eu

Unit A1 - A2
Southcity Business Centre
Whitestown Way
Tallaght
Dublin D24 HT95
Ireland