



*"Experts in Specialist
Wheels & Tyres"*

PRODUCT INFORMATION

300 Series Bolt Hole Castor

Material: Zinc plated swivel/brake bracket with bolt hole fitting. Wheel with grey thermoplastic rubber tread on polypropylene centre, electrically conductive.

Part number:	163000
Wheel diameter (D):	100mm
Tread width (T2):	32mm
Tread hardness:	85° Shore A
Electrical conductivity:	$\leq 10^4 \Omega$
Wheel bearing:	Plain bearing
Top plate diameter (C):	71mm
Bolt hole (d):	10.5mm
Brake pedal radius (G):	105mm
Overall height (H):	127mm
Load capacity 3km/h:	70kg
Rolling resistance:	Very good
Operating noise:	Good
Floor preservation:	Good

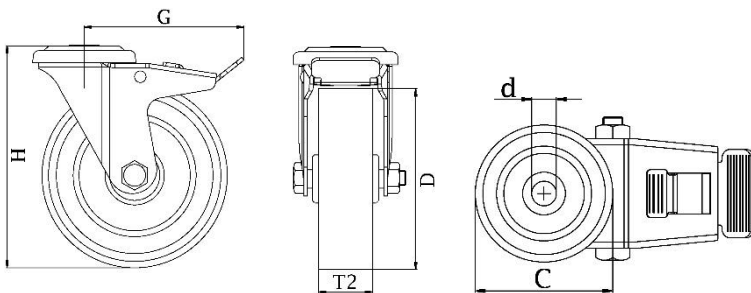

Telephone: (353) 1 452 0482
Email: info@parnell.eu

www.parnells.eu

Unit A1 - A2
Southcity Business Centre
Whitestown Way
Tallaght
Dublin D24 HT95
Ireland