



*"Experts in Specialist
Wheels & Tyres"*

PRODUCT INFORMATION

300SS Series Stainless Steel Bolt Hole Castor

Material: Swivel bracket in stainless steel with bolt hole fitting. Wheel with grey thermoplastic rubber tread on polypropylene centre.

Part number:	260004
Wheel diameter (D):	125mm
Tread width (T2):	32mm
Tread hardness:	85° Shore A
Wheel bearing:	Plain bearing
Top plate diameter (C):	70mm
Bolt hole (d):	13mm
Offset (F):	38mm
Overall height (H):	150mm
Load capacity 3km/h:	125kg
Rolling resistance:	Very good
Operating noise:	Good
Floor preservation:	Good

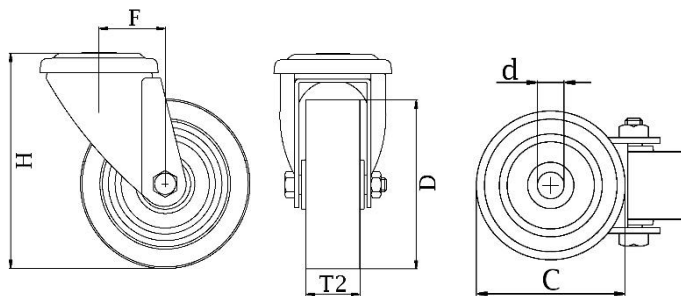

Telephone: (353) 1 452 0482
Email: info@parnell.eu

www.parnells.eu

Unit A1 - A2
Southcity Business Centre
Whitestown Way
Tallaght
Dublin D24 HT95
Ireland