



*"Experts in Specialist
Wheels & Tyres"*

PRODUCT INFORMATION

100SS Series Stainless Steel Bolt Hole Castor

Material: Swivel bracket in stainless steel with bolt hole fitting. White nylon wheel.

Part number:	250018
Wheel diameter (D):	75mm
Tread width (T2):	23mm
Tread hardness:	70° Shore D
Wheel bearing:	Plain bearing
Top plate diameter (C):	43mm
Bolt hole (d):	11mm
Offset (F):	29mm
Overall height (H):	98mm
Load capacity 3km/h:	75kg
Rolling resistance:	Excellent
Operating noise:	Reasonable
Floor preservation:	Reasonable

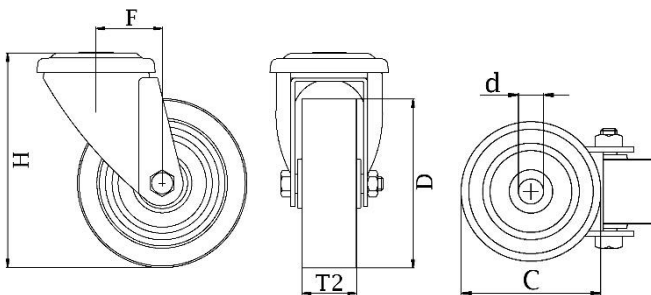

Telephone: (353) 1 452 0482
Email: info@parnell.eu

www.parnells.eu

Unit A1 - A2
Southcity Business Centre
Whitestown Way
Tallaght
Dublin D24 HT95
Ireland