



"Experts in Specialist
Wheels & Tyres"

PRODUCT INFORMATION

100SS Series Stainless Steel Bolt Hole Castor

Material: Swivel bracket in stainless steel with bolt hole fitting. Wheel with grey thermoplastic rubber tread on polypropylene centre, electrically conductive.

Part number:	540000
Wheel diameter (D):	50mm
Tread width (T2):	19mm
Tread hardness:	85° Shore A
Electrical conductivity:	$\leq 10^4 \Omega$
Wheel bearing:	Plain bearing
Top plate diameter (C):	43mm
Bolt hole (d):	11mm
Offset (F):	23mm
Overall height (H):	69mm
Load capacity 3km/h:	30kg
Rolling resistance:	Very good
Operating noise:	Good
Floor preservation:	Good

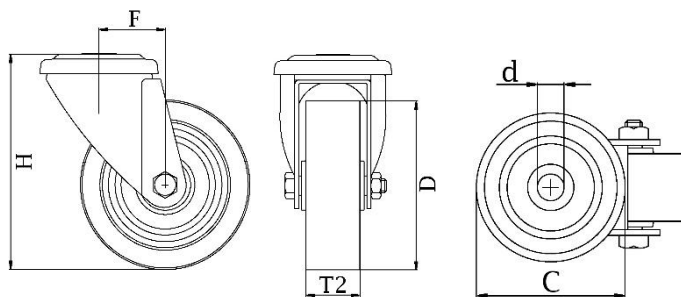

Telephone: (353) 1 452 0482
Email: info@parnell.eu

www.parnells.eu

Unit A1 - A2
Southcity Business Centre
Whitestown Way
Tallaght
Dublin D24 HT95
Ireland