



*"Experts in Specialist
Wheels & Tyres"*

PRODUCT INFORMATION

300SS Series Stainless Steel Bolt Hole Castor

Material: Swivel bracket in stainless steel with bolt hole fitting. Wheel with grey thermoplastic polyurethane tread on nylon centre, electrically conductive.

| | |
|---------------------------------|---------------------------------------|
| Part number: | 550000 |
| Wheel diameter (D): | 80mm |
| Tread width (T2): | 32mm |
| Tread hardness: | 94° Shore A |
| Electrical conductivity: | $\leq 10^4 \Omega$ |
| Wheel bearing: | Additional sealed single ball bearing |
| Top plate diameter (C): | 70mm |
| Bolt hole (d): | 13mm |
| Offset (F): | 38mm |
| Overall height (H): | 105mm |
| Load capacity 3km/h: | 100kg |
| Rolling resistance: | Very good |
| Operating noise: | Good |
| Floor preservation: | Good |

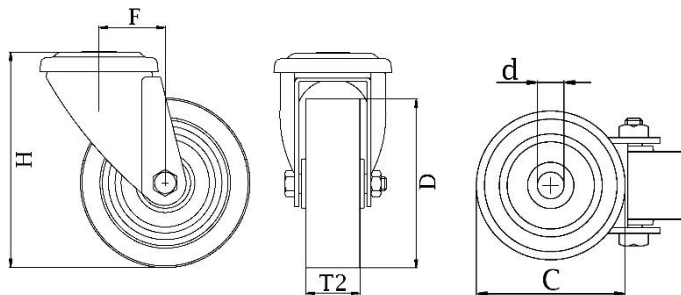

Telephone: (353) 1 452 0482
Email: info@parnell.eu

www.parnells.eu

Unit A1 - A2
Southcity Business Centre
Whitestown Way
Tallaght
Dublin D24 HT95
Ireland