



"Experts in Specialist  
Wheels & Tyres"

## PRODUCT INFORMATION

# Levelling Series Top Plate Castor

**Material:** Swivel bracket in die-cast aluminium with zinc plated steel top plate fitting. Black nylon wheel, truck lock made of hard rubber.

<b>Part number:</b>	757019
<b>Wheel diameter (D):</b>	50mm
<b>Tread width (T2):</b>	24mm
<b>Tread hardness:</b>	70° Shore D
<b>Wheel bearing:</b>	Plain bearing
<b>Top plate size (AxB):</b>	73x73mm
<b>Fixing hole spacing (axb):</b>	58x58mm
<b>Fixing hole size (d):</b>	7mm
<b>Offset (F):</b>	38mm
<b>Overall height (H):</b>	84mm
<b>Max overall height (h):</b>	90mm
<b>Adjustment range (T4):</b>	6mm
<b>Load capacity 1km/h:</b>	250kg
<b>Rolling resistance:</b>	Excellent
<b>Operating noise:</b>	Reasonable
<b>Floor preservation:</b>	Reasonable

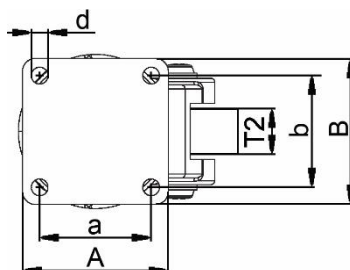
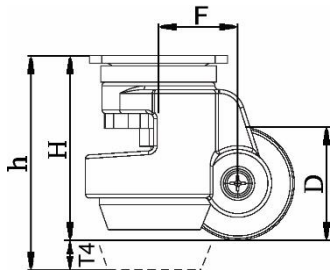

Telephone: (353) 1 452 0482  
Email: [info@parnells.eu](mailto:info@parnells.eu)

[www.parnells.eu](http://www.parnells.eu)

Unit A1 - A2  
Southcity Business Centre  
Whitestown Way  
Tallaght  
Dublin D24 HT95  
Ireland