



*"Experts in Specialist
Wheels & Tyres"*

PRODUCT INFORMATION

Levelling Series Top Plate Castor

Material: Swivel bracket in die-cast aluminium with zinc plated steel top plate fitting. Natural beige cast nylon wheel, truck lock made of aluminium.

Part number:	757022
Wheel diameter (D):	90mm
Tread width (T2):	55mm
Tread hardness:	80° Shore D
Wheel bearing:	Plain bearing
Top plate size (AxB):	100x100mm
Fixing hole spacing (axb):	70x70mm
Fixing hole size (d):	13mm
Offset (F):	70mm
Overall height (H):	130mm
Max overall height (h):	150mm
Adjustment range (T4):	20mm
Load capacity 1km/h:	2000kg
Rolling resistance:	Excellent
Operating noise:	Reasonable
Floor preservation:	Reasonable

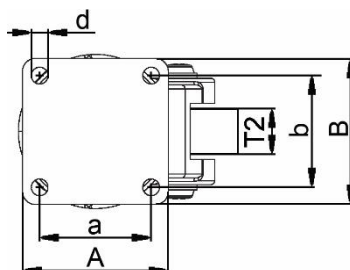
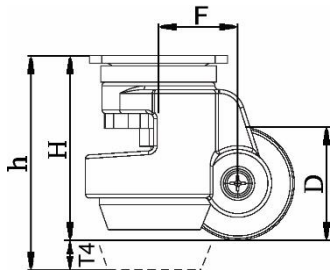

Telephone: (353) 1 452 0482
Email: info@parnell.eu

www.parnells.eu

Unit A1 - A2
Southcity Business Centre
Whitestown Way
Tallaght
Dublin D24 HT95
Ireland