



"Experts in Specialist
Wheels & Tyres"

PRODUCT INFORMATION

R Groove Wheel in Fixed Bracket

Material: Zinc plated steel

| | |
|---------------------|----------|
| Part number: | 101-R-FX |
| Ø(mm) | 100 |
| A(mm) | 25 |
| C(mm) | 37 |
| H(mm) | 105 |
| D(mm) | 20.5 |
| K(mm) | 90 |
| Max Load(Kg) | 200kg |

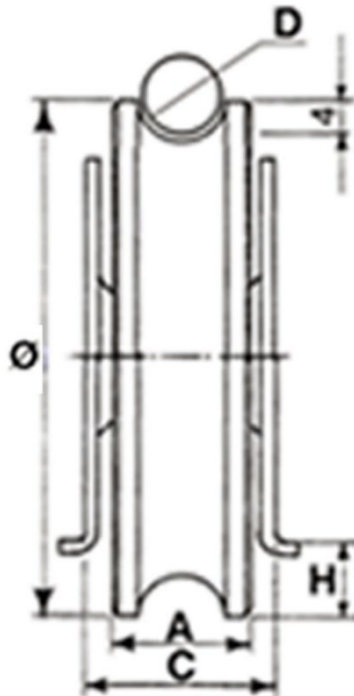
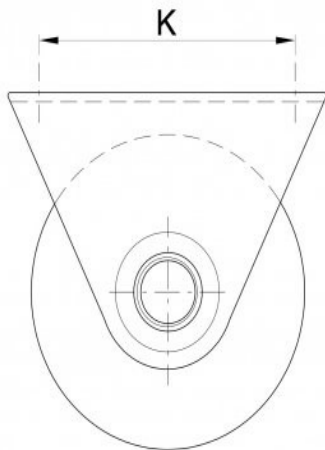

Telephone: (353) 1 452 0482
Email: info@parnells.eu

www.parnells.eu

Unit A1 - A4
Southcity Business Centre
Whitestown Way
Tallaght
Dublin D24 HT95
Ireland